

# Fuji USER MANUAL



www.fujitools.com

## ANGLE GRINDERS

MODELS : FA-45-2F, -3F, -5F, -6F, -7F, -12F



FA-45-2F



FA-45-3F



FA-45-5F



FA-45-6F



FA-45-7F



FA-45-12F



### SPECIFICATIONS

[Scan code to download this document and see this tool on our online catalogue.]

Model	Max. Dia (Grinding Wheel)		Rotational Frequency	Spindle Thread Size	Angle Head Height		Overall Length		Mass		Max. Air Consumption		Air Inlet Thread Size	Air Hose Size	
	mm	in			mm	in	mm	in	kg	lb	m <sup>3</sup> /min	cfm		mm	in
FA-45-2F N EC	125×6×22.2	5 x 1/4 x 7/8	10,900	M14 x 2.0 (M)	67	2.6	259	10.2	2.1	4.6	1.08	38.1	NPT 3/8	9.5	3/8
FA-45-3F N EC	125×6×22.2	5 x 1/4 x 7/8	10,900	5/8-11UNC (M)	67	2.6	259	10.2	2.1	4.6	1.08	38.1	NPT 3/8	9.5	3/8
FA-45-5F N EC	125×6×22.2	5 x 1/4 x 7/8	12,000	M14 x 2.0 (M)	67	2.6	259	10.2	2.1	4.6	1.14	40.3	NPT 3/8	9.5	3/8
FA-45-6F N EC	125×6×22.2	5 x 1/4 x 7/8	12,000	5/8-11UNC (M)	67	2.6	259	10.2	2.1	4.6	1.14	40.3	NPT 3/8	9.5	3/8
FA-45-7F N EC	125×6×22.2	5 x 1/4 x 7/8	7,000	5/8-11UNC (M)	67	2.6	259	10.2	2.1	4.6	0.82	29.0	NPT 3/8	9.5	3/8
FA-45-12F N EC	125×6×22.2	5 x 1/4 x 7/8	12,000	M8-P1.25 (F)	61	2.4	259	10.2	2.1	4.6	1.14	40.3	NPT 3/8	9.5	3/8

The performance figures are at 0.63 MPa(6.3bar).



Refer to "The Instructions and Warning for Safety Use" enclosed in each tool box.

Fuji Industrial Technique Co.,Ltd.

2-1-14, Kamiji, Higashinari-ku, Osaka, 537-0003 Japan

Tel : 81-6-6972-2335

Fax : 81-6-6972-2380

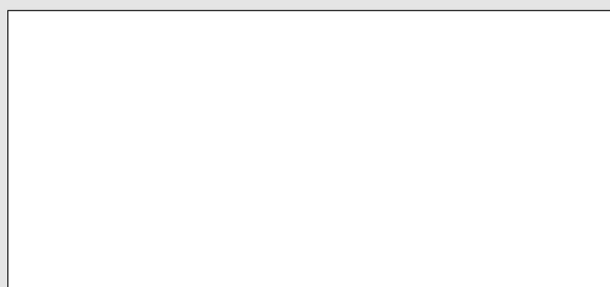

# MODELS : FA-45-2F, -3F, -5F, -6F, -7F, -12F

## EXPLODED VIEW

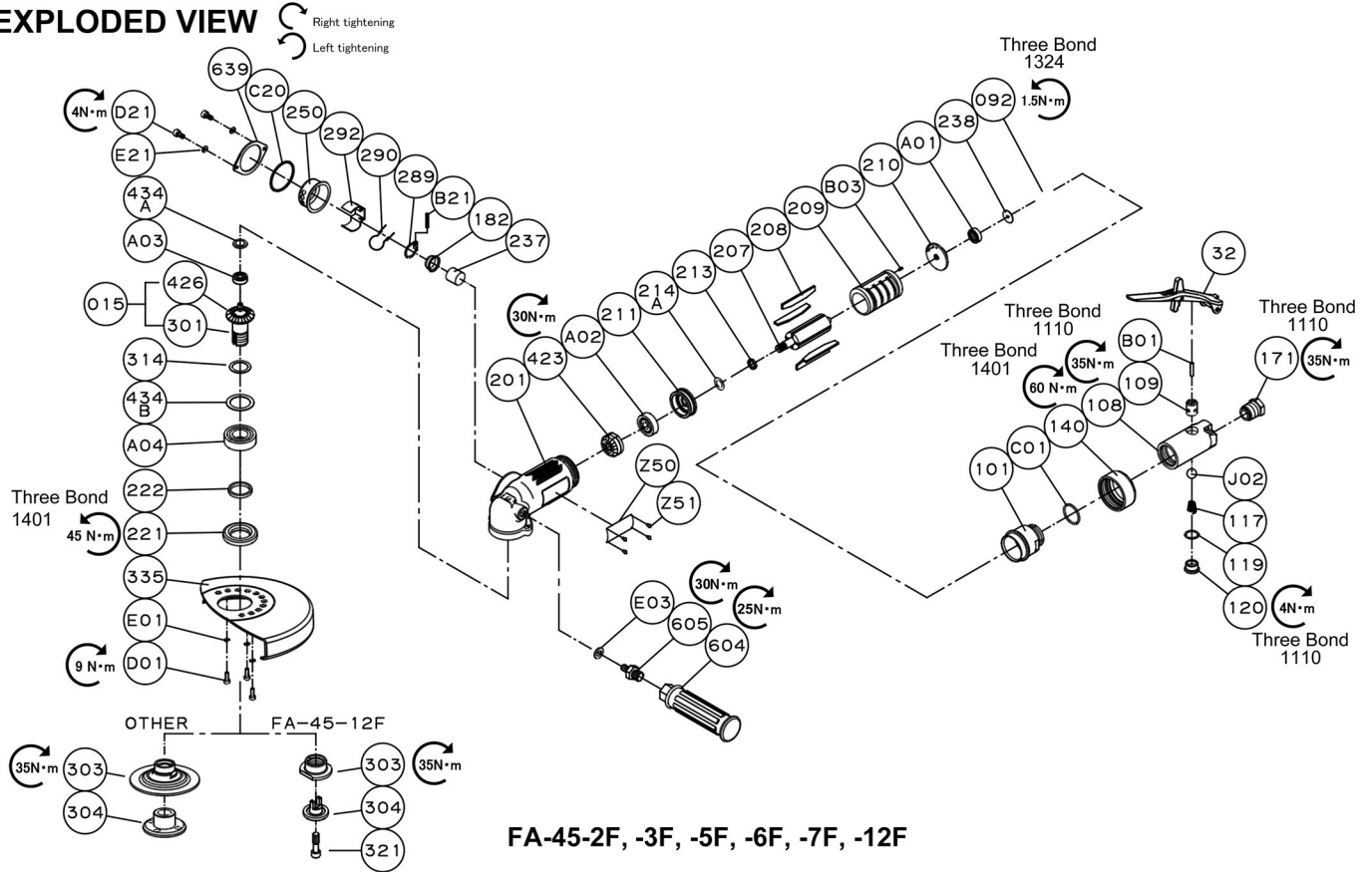

FA-45-2F, -3F, -5F, -6F, -7F, -12F

## PARTS LIST

Index No.	Fuji No.	Parts No.	Parts Name	Qty
<b>FA-45-2F, -3F, -5F, -6F, -7F, -12F</b>				
—	A-206001-00	5412104915	Housing Cover Assy (NPT)	1
101	A-200101-01	5412070113	Housing Cover	1
140	A-200140-00	5412060604	Cup Nut	1
—	NP-0740	5412060277	Warning Sticker	1
—	NP-0742	5412060282	Warning Sticker	1
C01	O-S26	5412055235	"O"Ring	1
—	A-206003-00	5412104916	Throttle Valve Body Assy (NPT)	1
108	A-206108-00	5412104910	Throttle Valve Body	1
(109)	—	—	Throttle Valve Bushing	1
117	G-105117-00	5412053828	Throttle Valve Spring	1
119	G-028119-00	5412053727	Throttle Valve Cover Packing	1
120	G-028120-00	5412053728	Throttle Valve Cover	1
171	IB-403NS0	5412054490	Inlet Bushing (NPT)	1
B01	NR-423FR	5412055147	Throttle Valve Rod	1
J02	B-1/2U	5412070178	Ball	1
—	NP-0445	5412104436	CE Sticker	1
32	A-203019-01	5412105215	(F) Lock Lever Assy	1
—	A-200012-00	5412070111	Exhaust Cover Assy	1
182	W-065182-00	5412056711	Strainer	1
237	A-094237-00	5412050489	Muffler Pad	1
250	A-200250-00	5412060618	Exhaust Cover	1
289	A-110289-00	5412050602	Muffler Plate	1
290	A-200290-00	5412060619	Muffler Spring	1
292	A-110292-00	5412050604	Muffler Plate Holder	1
B21	SP-322	5412056283	Spring Pin	1
C20	O-S40	5412055255	"O"Ring	1
—	A-206072-03	5412104957	Wheel Guard Assy	1
335	A-206335-00	5412104880	Wheel Guard	1
D01	CS-512	5412070413	Cap Screw	3
E01	SW-5	5412056414	Spring Washer	3
—	NP-0741	5412060281	Label	1
201	A-200201-00	5412060606	Housing	1
207	A-200207-00	5412060607	Rotor	1

□ Spare parts without part number are not sold separately.  
 □ The related parts are shown in a thick frame.  
 □ #108 and 209 are supplied together with parts shown in ( ).  
 □ Specify parts number and quantity when ordering.

Index No.	Fuji No.	Parts No.	Parts Name	Qty
209	A-200209-00	5412060609	Cylinder	1
(B03)	SP-26	5412056272	Spring Pin	1
210	A-200210-00	5412060610	Cylinder Upper Plate	1
211	A-200211-00	5412060611	Cylinder Lower Plate	1
213	A-200213-00	5412060612	Adjusting Collar	1
214A	G-144214-00	5412053946	A. Washer (T=0.03)	(1)
—	G-144214-01	5412053947	A. Washer (T=0.05)	(1)
221	A-200221-00	5412060616	Spindle Bearing Cover	1
222	A-200222-00	5412060617	Felt Ring	1
238	A-108238-01	5412069929	Bearing Cover (B)	1
314	A-109314-00	5412050586	Wheel Spindle Washer (T=0.5)	(1)
—	A-109314-01	5412050587	Wheel Spindle Washer (T=0.3)	(1)
—	A-109314-02	5412050588	Wheel Spindle Washer (T=0.2)	(1)
434A	A-021434-00	5412050332	Bearing Washer	1
434B	A-093434-00	5412050468	Bearing Washer	1
604	A-025604-02	5412050341	Dead Handle	1
605	A-107605-00	5412050555	Dead Handle Joint	1
639	A-107639-00	5412050556	Exhaust Cover Holder	1
A01	BB-607	5412050984	Ball Bearing	1
A02	BB-6200	5412050991	Ball Bearing	1
A03	BB-626	5412051013	Ball Bearing	1
A04	BB-6004ZZ	5412050977	Ball Bearing	1
D21	CS-510B	5412051168	Button Head Cap Screw	2
E03	PW-8	5412055414	Washer	1
E21	SW-5	5412056414	Spring Washer	2
Z51	NPN-0X3.2	5412055056	Screw Rivet	4
—	A-200090-00	5412103996	Blade Set	1
208	A-200208-00	5412060608	Rotor Blade	4

### ■ Standard Accessories(FA-45-2F, -3F, -5F, -6F, -7F)

AC No.	Parts No.	Description	Qty
F-110	5412052061	26mm Open-End Wrench	1
F-203	5412052087	32mm Open-End Pin Wrench	1
F-704	5412052207	4mm Hex.Pin Wrench	1
F-707	5412052210	1/4 in Hex.Pin Wrench	1

### ■ Standard Accessories(FA-45-12F)

AC No.	Parts No.	Description	Qty
F-134	5412052071	41mm Open-End Wrench	1
F-704	5412052207	4mm Hex.Pin Wrench	1
F-706	5412052209	6mm Hex.Pin Wrench	1

FA-45-2F				
303	A-206303-03	5412104949	Wheel Flange (A)	1
304	A-206304-03	5412104950	Wheel Flange (B)	1
Z50	NP-0147	5412104932	Name Plate	1
—	A-206091-01	5412105222	Bevel Gear Kit	1
423	A-200423-00	5412060624	Bevel Pinion	1
015	A-206015-03	5412104952	Wheel Spindle Assy	1
301	A-206301-03	5412104947	Wheel Spindle	1
426	A-200426-00	5412060625	Bevel Gear	1
092	A-206092-00	5412104888	Governor	1
FA-45-3F				
303	A-206303-02	5412104948	Wheel Flange (A)	1
304	A-192304-09	5412104277	Wheel Flange (B)	1
Z50	NP-0148	5412104933	Name Plate	1
—	A-206091-02	5412105223	Bevel Gear Kit	1
423	A-200423-00	5412060624	Bevel Pinion	1
015	A-206015-02	5412104951	Wheel Spindle Assy	1
301	A-206301-02	5412104946	Wheel Spindle	1
426	A-200426-00	5412060625	Bevel Gear	1
092	A-206092-00	5412104888	Governor	1
FA-45-5F				
303	A-206303-03	5412104949	Wheel Flange (A)	1
304	A-206304-03	5412104950	Wheel Flange (B)	1
Z50	NP-0149	5412104934	Name Plate	1
—	A-206091-01	5412105222	Bevel Gear Kit	1
423	A-200423-00	5412060624	Bevel Pinion	1
015	A-206015-03	5412104952	Wheel Spindle Assy	1
301	A-206301-02	5412104947	Wheel Spindle	1
426	A-200426-00	5412060625	Bevel Gear	1
092	A-206092-01	5412104889	Governor	1
FA-45-6F				
303	A-206303-02	5412104948	Wheel Flange (A)	1
304	A-192304-09	5412104277	Wheel Flange (B)	1
Z50	NP-0150	5412104935	Name Plate	1
—	A-206091-02	5412105223	Bevel Gear Kit	1
423	A-200423-00	5412060624	Bevel Pinion	1
015	A-206015-02	5412104951	Wheel Spindle Assy	1
301	A-206301-02	5412104946	Wheel Spindle	1
426	A-200426-00	5412060625	Bevel Gear	1
092	A-206092-01	5412104889	Governor	1
FA-45-7F				
303	A-206303-02	5412104948	Wheel Flange (A)	1
304	A-192304-09	5412104277	Wheel Flange (B)	1
Z50	NP-0151	5412104936	Name Plate	1
—	A-206091-02	5412105223	Bevel Gear Kit	1
423	A-200423-00	5412060624	Bevel Pinion	1
015	A-206015-02	5412104951	Wheel Spindle Assy	1
301	A-206301-02	5412104946	Wheel Spindle	1
426	A-200426-00	5412060625	Bevel Gear	1
092	A-206092-03	5412104955	Governor	1
FA-45-12F				
303	A-206303-00	5412104877	Wheel Flange (A)	1
304	A-206304-02	5412105559	Wheel Flange (B)	1
321	A-021321-01	5412050330	Detent Bolt	1
Z50	NP-0157	5412105557	Name Plate	1
—	A-206091-00	5412105221	Bevel Gear Kit	1
423	A-200423-00	5412060624	Bevel Pinion	1
015	A-206015-00	5412104892	Wheel Spindle Assy	1
301	A-206301-02	5412104876	Wheel Spindle	1
426	A-200426-00	5412060625	Bevel Gear	1
092	A-206092-01	5412104889	Governor	1