

Fuji USER MANUAL

F1 SHUT WRENCHES

MODELS :FET-13-1



FET-13-1

 Refer to " The instructions and Warning for Safety Use " enclosed in each tool box.

SPECIFICATIONS

Model	Bolt Size	Recommended Torque Range (0.4~0.63MPa)	Rotational Frequency	Square Drive Size	Air Consumption (At Load)	Mass (without socket)	Overall Length (without socket)	Air Inlet Thread Size	Air Hose Size
	mm	N·m	min ⁻¹	mm	m ³ /min	kg	mm		mm
FET-13-1	M12~M14	90~160	3,800	12.7	0.85	2.30	217	PT1/4	9.5

※ The performance figures are at 0.63MPa(6.3bar).

Fuji Industrial Technique Co.,Ltd.

2-1-14, Kamiji, Higashinari-ku, Osaka, 537-0003 Japan

Tel : 81-6-6972-2335

Fax : 81-6-6972-2380

MODEL :FET-13-1

EXPLODED VIEW

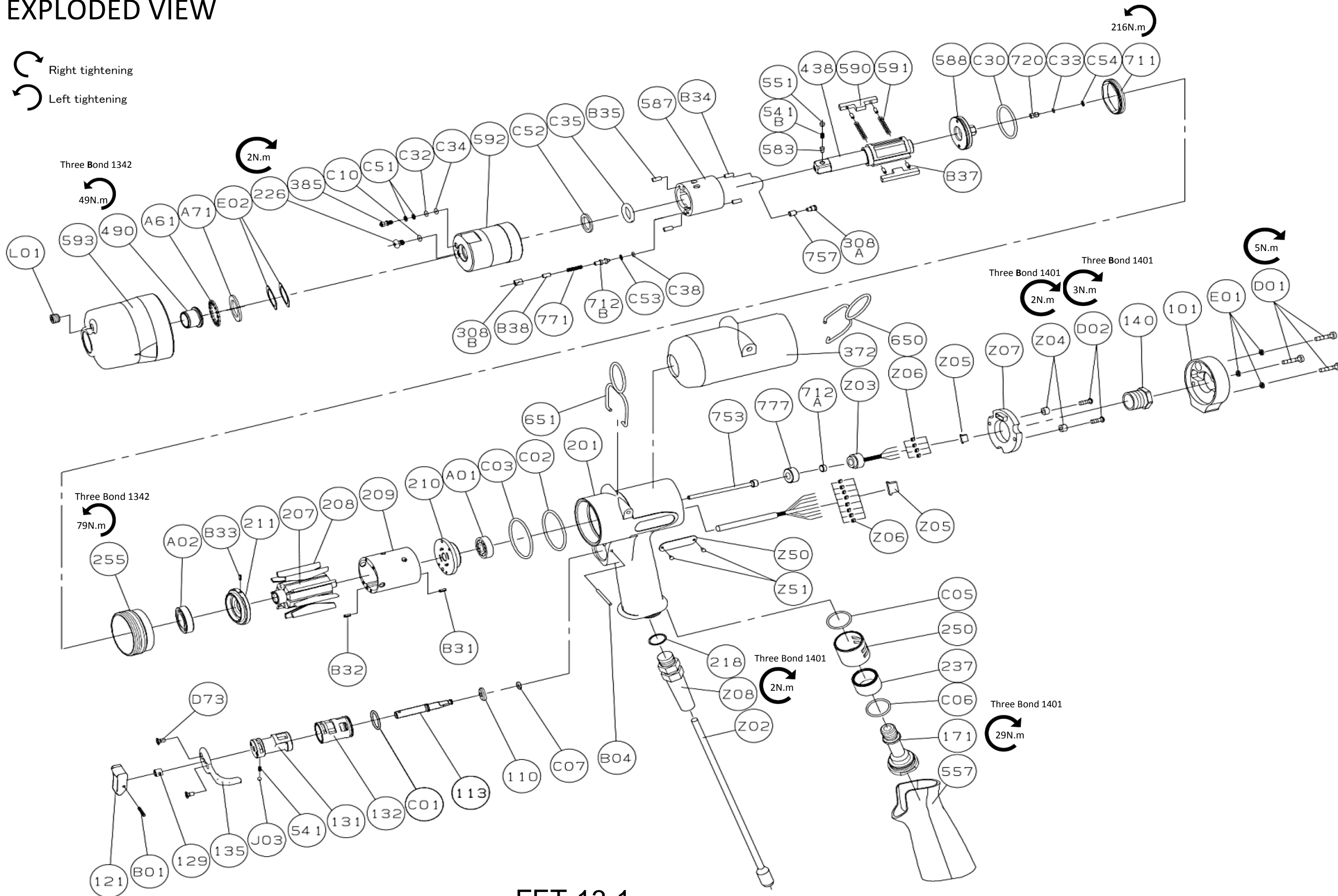

FET-13-1

PARTS LIST

Index No.	Parts No.	Parts Name	Qty	Index No.	Parts No.	Parts Name	Qty	Index No.	Parts No.	Parts Name	Qty
FET-13-1											
-	W-392006-00	Housing Ass'y		588	W-392588-00	Oil Cylinder Upper Plate	1	D01	CS-420	Cap Screw	3
110	W-372110-00	Throttle Valve	1	590	W-375590-00	Spindle Blade	2	D02	CS-310B	Button Head Cap Screw	2
113	W-372113-00	Throttle Valve Rod	1	(B37)	SP-2.55	Spring Pin	4	E01	SW-4	Wave Washer	3
121	W-254121-00	Throttle Valve Lever	1	591	W-375591-00	Blade Spring	2	E03	WW-16	Wave Washer	2
129	W-372129-00	Throttle Valve Rod Bushing	1	592	W-385592-00	Cylinder Case	1	Z03		Pressure Sensor	1
131	W-374131-00	Reverse Valve	1	711	W-385711-00	Cylinder Cover	1	(Z05)		Housing	1
132	W-282132-01	Reverse Valve Bushing	1	712B	W-373712-00	Damper	1	(Z06)		Contact	4
135	W-374135-00	Reverse Valve Lever	1	720	W-389720-00	Piston	1	Z04	SPA-0001	Spacer	2
171	W-374171-00	Inlet Joint	1	757	W-224757-00	Needle	1	Z07		PC Board	1
201	W-392201-00	Housing	1	771	W-373771-00	Spring	1	Z50	NP-8015	Name Plate	1
218	W-377218-00	Packing	1	B34	NR-3.057	Needle Roller	2	Z51	NPN-OX3.2	Screw Rivet	2
237	W-282237-00	Muffler Pad	1	B35	NR-3.057	Needle Roller	2		NP-0740	Warning Sticker	1
250	W-283250-01	Exhaust Cover	1	B38	NR-314	Needle Roller	1	<input type="checkbox"/> The related parts are shown in a thick frame. <input type="checkbox"/> #209 #211, #590 and #Z03 are supplied together with parts shown in (). <input type="checkbox"/> Special tool is necessary for Cable Kit and #Z03 please contact your Fuji representative. <input type="checkbox"/> For repair / replacement of electronic parts(#Z07) please contact your Fuji representative. <input type="checkbox"/> Specify parts number and quantity when ordering.			
541A	W-252541-00	Button Retainer Spring	1	C10	O-S2.5F(H)	"O" Ring (HNBR80)	1				
557	W-371557-00	Protector	1	C30	O-S42(H)	"O" Ring (HNBR80)	1				
B01	SP-212	Spring Pin	1	C32	O-S2F(H)	"O" Ring (HNBR80)	1				
B04	GP-226GLC	Grooved Pin	1	C33	O-S2.5F(H)	"O" Ring (HNBR80)	1				
C01	O-S17	"O" Ring	1	C34	O-S3(H)	"O" Ring (HNBR80)	1				
C02	O-S50	"O" Ring	1	C35	O-KX16(H)	"X"Ring (HNBR80)	1				
C03	O-S50	"O" Ring	1	C38	O-S2.5F(H)	"O" Ring (HNBR80)	1				
C05	O-S22	"O" Ring	1	C51	BR-S2.5FT2	Back-Up Ring	2				
C06	O-S22	"O" Ring	1	C52	BR-115	Back-Up Ring	1				
C07	O-568-0004	"O" Ring	1	C53	BR-S3FT2	Back-Up Ring	1				
D73	CS-36S	Set Screw(Dog Point)	1	C54	BR-S2.5FT2	Back-Up Ring	1				
J03	B-3	Steel Ball	1	101	W-392101-00	Housing Cover	1				
Z08	IZL-0003	Cable Protector	1	140	W-377140-00	Cup Nut	1				
-	5412104145	Cable Kit		207	W-375207-00	Rotor	1				
Z02		Cable Ass'y	1	208	W-375208-00	Rotor Blade	9				
Z05		Housing	1	209	W-385209-00	Cylinder	1				
Z06		Contact	8	(B31)	SP-38	Spring Pin	1				
-	W-375033-00	Front Case Ass'y		B32	SP-38	Spring Pin	1				
490	W-373490-00	Spindle Bushing	1	210	W-375210-00	Cylinder Upper Plate	1				
593	W-375593-00	Front Case	1	211	W-375211-00	Cylinder Lower Plate	1				
L01	PL-1/16	Plug	1	(B33)	SP-1.56	Spring Pin	1				
-	W-392021-01	Oil Cylinder Ass'y <BF>		255	W-385255-00	Motor Fastening Nut	1				
226	W-371226-00	Oil Plug	1	372	W-392372-00	Plastic Cover	1				
308A	W-375308-00	Spacer	1	650	W-392650-00	Hanger (Vertical)	1				
308B	W-385308-00	Spacer	1	651	W-371651-00	Hanger (Horizontal)	1				
385	W-385385-00	Adjusting Screw	1	712A	W-300712-00	Damper	1				
438	W-385438-01	Spindle<BF>	1	753	W-392753-00	Piston Rod	1				
541B	W-224541-00	Button Retainer Spring	1	777	W-300777-00	Collar	1				
551	W-224551-00	Plug	1	A01	BB-6902	Ball Bearing	1				
583	W-224583-00	Retainer Button (F)	1	A02	BB-6903ZZ	Ball Bearing	1				
587	W-385587-00	Oil Cylinder	1	A61	NB-NTB1624NE	Thrust Needle Bearing	1				
				A71	TW-AS1624E	Thrust Washer	1				

Standard Accessories

AC No.	Description	Qty
F-701-1	1.5mm Hex. Pin Wrench	1
F-704	4mm Hex. Pin Wrench	1
IB-202N00	Inlet Bushing (for NPT only)	1