

## F1 SHUT WRENCHES

MODELS : FET-5-1 & FET-5D-1



FET-5-1



FET-5D-1

< BIT SIZE >

	FET-5D-1
	A: 9.5mm
	B: 12mm

Refer to "The instructions and Warning for Safety Use" enclosed in each tool box.

### SPECIFICATIONS

Model	Bolt Size	Recommended Torque Range	Rotational Frequency	Square Drive Size	Bit Shank Size	Air Consumption (At Load)	Mass (without socket)	Overall Length (without socket)	Air Inlet Thread Size	Air Hose Size
		(0.4~0.63MPa)								
	mm	N·m	min <sup>-1</sup>	mm	mm	m <sup>3</sup> /min	kg	mm		mm
FET-5-1	M6~M8	11~24	6,300	9.5	-	0.40	0.96	162	PTor NPT 1/4	6.3
FET-5D-1	M6~M8	11~22	6,300	-	6.35	0.40	0.96	162	PTor NPT 1/4	6.3

※ The performance figures are at 0.63MPa(6.3bar).

Fuji Industrial Technique Co.,Ltd.

2-1-14, Kamiji, Higashinari-ku, Osaka, 537-0003 Japan

Tel : 81-6-6972-2335

Fax : 81-6-6972-2380

# MODELS : FET-5-1 & FET-5D-1

分解図

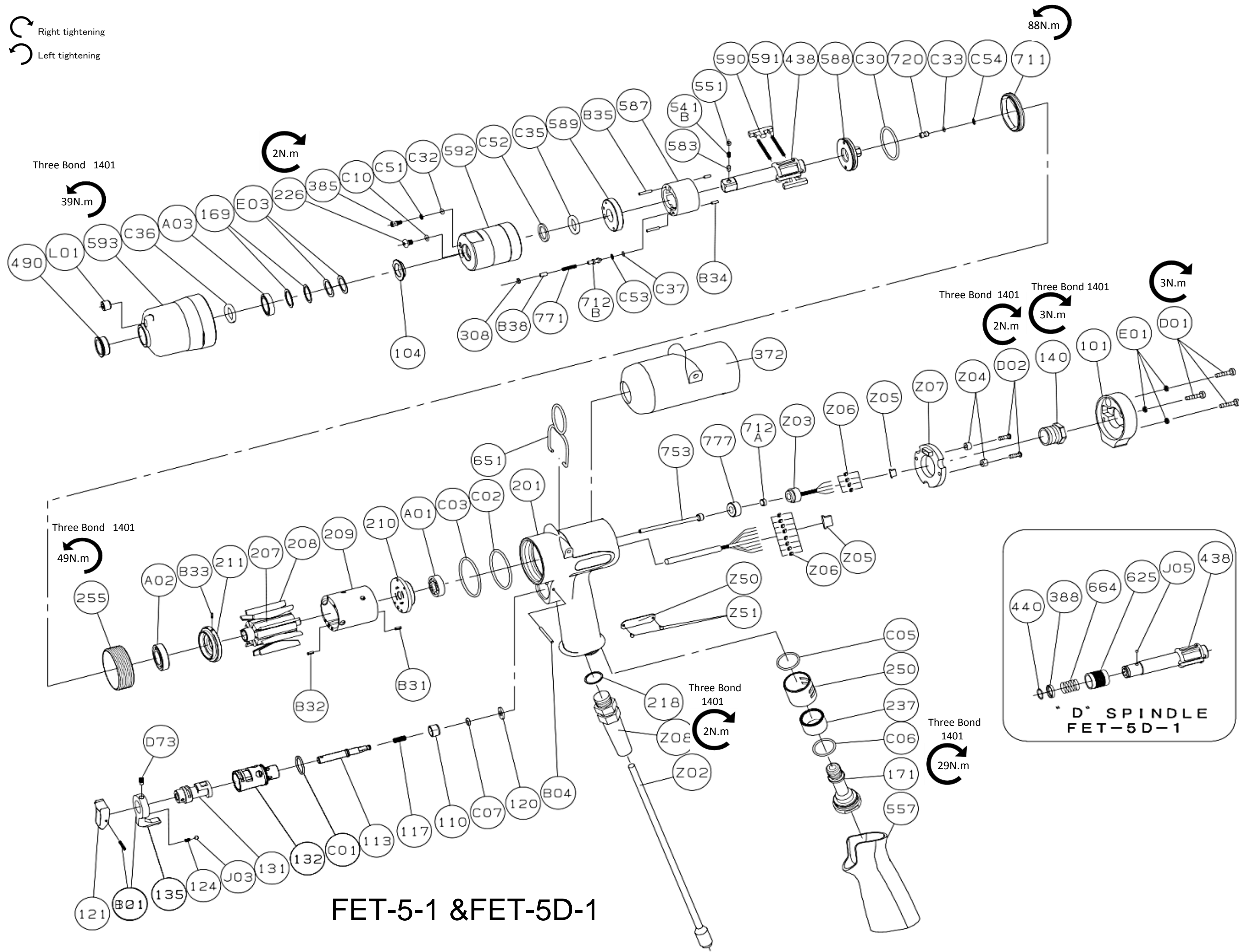
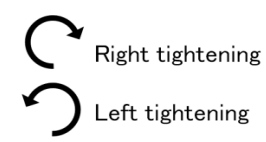

## PARTS LIST

Index No.	Parts No.	Parts Name	Qty.
<b>FET-5-1</b>			
—	W-387006-00	Housing Ass'y	
110	W-371110-00	Throttle Valve	1
113	W-362113-00	Throttle Valve Rod	1
117	W-362117-00	Throttle Valve Spring	1
120	W-371120-00	Throttle Valve Cover	1
121	W-254121-00	Throttle Valve Lever	1
124	W-254124-00	Knock Spring	1
131	W-276131-00	Reverse Valve	1
132	W-276132-01	Reverse Valve Bushing	1
135	W-254135-00	Reverse Valve Lever	1
171	W-371171-00	Inlet Joint	1
201	W-387201-00	Housing	1
218	W-377218-00	Packing	1
237	W-310237-00	Muffler Pad	1
250	W-302250-00	Exhaust Cover	1
557	W-371557-00	Protector	1
B01	SP-212	Spring Pin	1
B04	GP-224GLC	Grooved Pin	1
C01	O-S15	"O" Ring	1
C02	O-S34	"O" Ring	1
C03	O-S34	"O" Ring	1
C05	O-S18	"O" Ring	1
C06	O-S18	"O" Ring	1
C07	O-P3(H)	"O" Ring (HNBR80)	1
D73	SS-46D	Set Screw(Dog Point)	1
J03	B-3	Steel Ball	1
Z08	IZL-0003	Cable Protector	1
—	5412104145	Cable Kit	
Z02		Cable Ass'y	1
Z05		Housing	1
Z06		Contact	8
—	W-387033-00	Front Case Ass'y	
490	W-387490-00	Spindle Bushing	1
593	W-370593-00	Front Case	1
A03	BB-6701	Ball Bearing	1
C36	O-S12	"O" Ring	1
L01	PL-1/16	Plug	1
—	W-387021-01	Oil Cylinder Ass'y <BF>	
104	W-254104-00	Bushing	1
226	W-184226-00	Oil Plug	1
308	W-371308-00	Spacer	1
385	W-379385-00	Adjusting Screw	1
438	W-379438-01	Spindle	1
541	W-252541-00	Button Retainer Spring	1
551	W-252551-00	Plug	1

Index No.	Parts No.	Parts Name	Qty.
583	W-252583-00	Retainer Button (F)	1
587	W-379587-00	Oil Cylinder	1
588	W-387588-00	Oil Cylinder Upper Plate	1
589	W-379589-00	Oil Cylinder Lower Plate	1
590	W-370590-00	Spindle Blade	2
591	W-371591-00	Blade Spring	2
592	W-379592-00	Cylinder Case	1
711	W-371711-00	Cylinder Cover	1
712B	W-371712-00	Damper	1
720	W-302720-00	Piston	1
771	W-370771-00	Spring	1
B34	NR-25.8F	Needle Roller	2
B35	NR-211.8	Needle Roller	2
B38	NR-36	Needle Roller	1
C10	O-S3(H)	"O" Ring (HNBR80)	1
C30	O-S27.5F(H)	"O" Ring (HNBR80)	1
C32	O-S2F(H)	"O" Ring (HNBR80)	1
C33	O-S2.5F(H)	"O" Ring (HNBR80)	1
C35	O-KX12(H)	"X"Ring (HNBR80)	1
C37	O-S1.4F(H)	"O" Ring (HNBR80)	1
C51	BR-S2.5FT2	Back-Up Ring	1
C52	BR-112	Back-Up Ring	1
C53	BR-S2.5FT2	Back-Up Ring	1
C54	BR-S2.5FT2	Back-Up Ring	1
101	W-387101-00	Housing Cover	1
140	W-377140-00	Cup Nut	1
169	W-070169-01	Reverse Valve Washer	2
207	W-370207-00	Rotor	1
208	W-370208-00	Rotor Blade	9
209	W-370209-00	Cylinder	1
B31	SP-2.56	Spring Pin	1
B32	SP-2.56	Spring Pin	1
210	W-371210-00	Cylinder Upper Plate	1
211	W-371211-00	Cylinder Lower Plate	1
(B33)	SP-25	Spring Pin	1
255	W-371255-00	Motor Fastening Nut	1
372	W-387372-00	Plastic Cover	1
651	W-371651-00	Hanger (Horizontal)	1
712A	W-300712-00	Damper	1
753	W-387753-00	Piston Rod	1
777	W-300777-00	Collar	1
A01	BB-EE2	Ball Bearing	1
A02	BB-6901	Ball Bearing	1
D01	CS-316	Cap Screw	3
D02	CS-310B	Button Head Cap Screw	2
E01	SW-3	Wave Washer	3

Index No.	Parts No.	Parts Name	Qty.
E03	WW-12	Wave Washer	2
Z03		Pressure Sensor	1
Z05		Housing	1
Z06		Contact	4
Z04	SPA-0001	Spacer	2
Z07		PC Board	1
Z50	NP-8008	Name Plate	1
Z51	NPN-0X3.2	Screw Rivet	2
	NP-0740	Warning Sticker	1
It is common with FET-5-1 excluding the parts below.			
<b>FET-5D-1</b>			
—	W-387021-02	Oil Cylinder Ass'y	
438	W-379438-02	Spindle	1
388	W-305388-00	Spring Holder	1
440	W-305440-00	Ring	1
625	W-305625-00	Bit Cover	1
664	W-305664-00	Finder Spring	1
J05	B-3	Ball	1

- The related parts are shown in a thick frame.
- #209 #211 and #Z03 are supplied together with parts shown in ( ).
- Special tool is necessary for Cable Kit and #Z03  
please contact your Fuji representative.
- For repair / replacement of electronic parts(#Z07)  
please contact your Fuji representative.
- Specify parts number and quantity when ordering.

### Standard Accessories

AC No.	Description	Qty.
F-701-1	1.5mm Hex. Pin Wrench	1
F-704	4mm Hex. Pin Wrench	1
IB-202N00	Inlet Bushing (for NPT only)	1