



USER MANUAL

F1 SHUT WRENCHES

MODELS : FET-4-1 & FET-4D-1



FET-4-1



FET-4D-1

< BIT SIZE >

	FET-4D-1
	A: 9.5mm
	B: 12mm

Refer to "The instructions and Warning for Safety Use" enclosed in each tool box.

SPECIFICATIONS

Model	Bolt Size	Recommended	Rotational	Square	Bit	Air	Mass	Overall Length	Air Inlet	Air Hose
		Torque Range (0.4~ 0.63MPa)								
	mm	N·m	min ⁻¹	mm	mm	m ³ /min	kg	mm		mm
FET-4-1	M5~M6	5~12	6,700	9.5	-	0.36	0.96	162	PTor NPT 1/4	6.3
FET-4D-1	M5~M6	5~12	6,700	-	6.35	0.36	0.96	162	PTor NPT 1/4	6.3

※ The performance figures are at 0.63MPa(6.3bar).

Fuji Industrial Technique Co.,Ltd.

2-1-14, Kamiji, Higashinari-ku, Osaka, 537-0003 Japan

Tel : 81-6-6972-2335

Fax : 81-6-6972-2380

MODELS : FET-4-1 & FET-4D-1

分解図

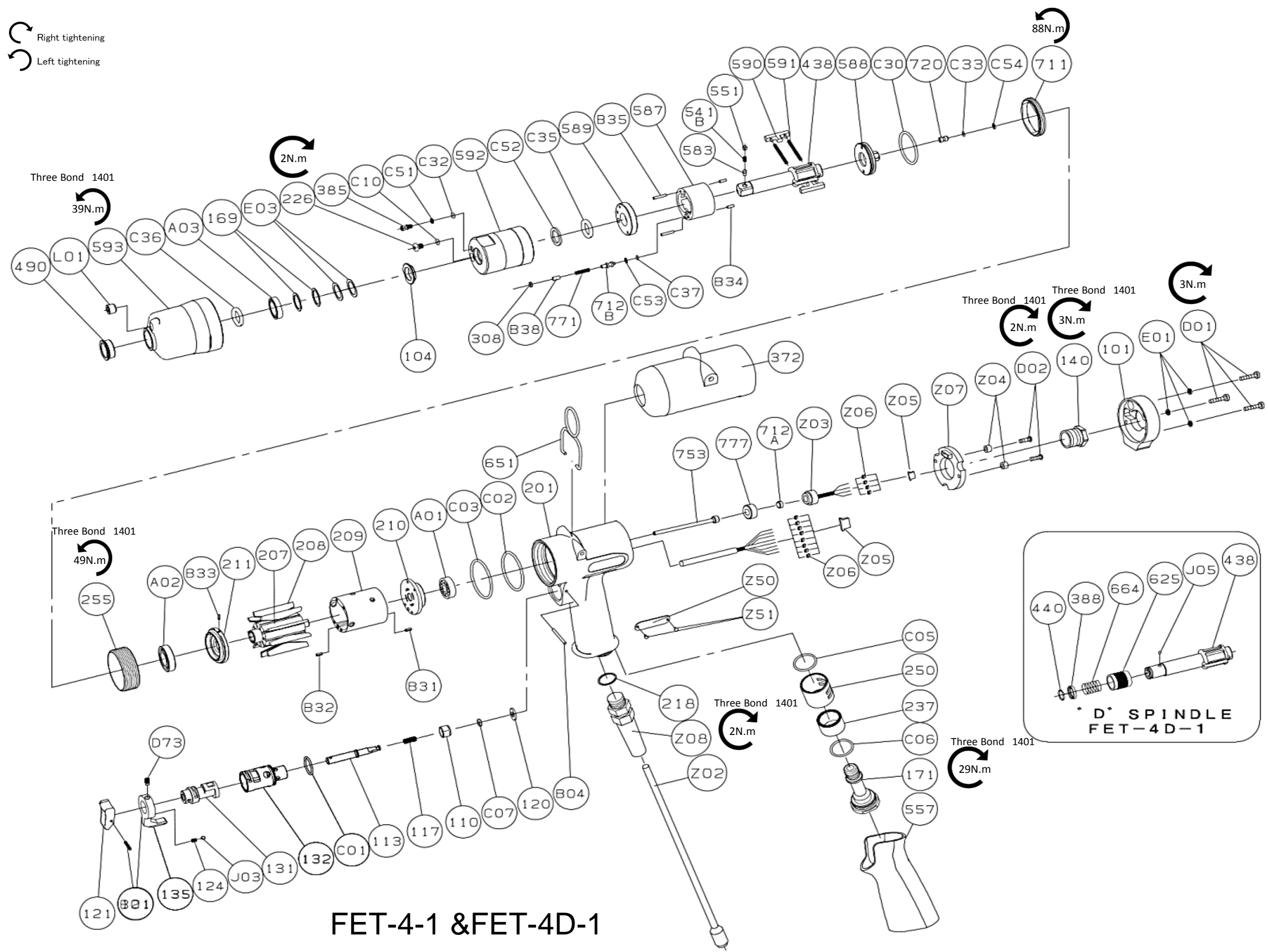
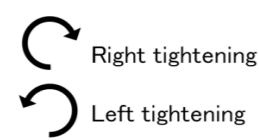

PARTS LIST

Index No.	Parts No.	Parts Name	Qty	Index No.	Parts No.	Parts Name	Qty	Index No.	Parts No.	Parts Name	Qty
FET-4-1											
—	W-387006-00	Housing Ass'y		583	W-252583-00	Retainer Button (F)	1	E03	WW-12	Wave Washer	2
110	W-371110-00	Throttle Valve	1	587	W-379587-00	Oil Cylinder	1	Z03		Pressure Sensor	1
113	W-362113-00	Throttle Valve Rod	1	588	W-387588-00	Oil Cylinder Upper Plate	1	Z05		Housing	1
117	W-362117-00	Throttle Valve Spring	1	589	W-379589-00	Oil Cylinder Lower Plate	1	Z06		Contact	4
120	W-371120-00	Throttle Valve Cover	1	590	W-370590-00	Spindle Blade	2	Z04	SPA-0001	Spacer	2
121	W-254121-00	Throttle Valve Lever	1	591	W-371591-00	Blade Spring	2	Z07		PC Board	1
124	W-254124-00	Knock Spring	1	592	W-379592-00	Cylinder Case	1	Z50	NP-8007	Name Plate	1
131	W-276131-00	Reverse Valve	1	711	W-371711-00	Cylinder Cover	1	Z51	NPN-0X3.2	Screw Rivet	2
132	W-276132-01	Reverse Valve Bushing	1	712B	W-371712-00	Damper	1	NP-0740		Warning Sticker	1
135	W-254135-00	Reverse Valve Lever	1	720	W-302720-00	Piston	1	It is common with FET-4-1 excluding the parts below.			
171	W-371171-00	Inlet Joint	1	771	W-370771-00	Spring	1	FET-4D-1			
201	W-387201-00	Housing	1	B34	NR-25.8F	Needle Roller	2	—	W-387021-02	Oil Cylinder Ass'y	
218	W-377218-00	Packing	1	B35	NR-211.8	Needle Roller	2	438	W-379438-02	Spindle	1
237	W-310237-00	Muffler Pad	1	B38	NR-36	Needle Roller	1	388	W-305388-00	Spring Holder	1
250	W-302250-00	Exhaust Cover	1	C10	O-S3(H)	"O" Ring (HNBR80)	1	440	W-305440-00	Ring	1
557	W-371557-00	Protector	1	C30	O-S27.5F(H)	"O" Ring (HNBR80)	1	625	W-305625-00	Bit Cover	1
B01	SP-212	Spring Pin	1	C32	O-S2F(H)	"O" Ring (HNBR80)	1	664	W-305664-00	Finder Spring	1
B04	GP-224GLC	Grooved Pin	1	C33	O-S2.5F(H)	"O" Ring (HNBR80)	1	J05	B-3	Ball	1
C01	O-S15	"O" Ring	1	C35	O-KX12(H)	"X" Ring (HNBR80)	1				
C02	O-S34	"O" Ring	1	C37	O-S1.4F(H)	"O" Ring (HNBR80)	1				
C03	O-S34	"O" Ring	1	C51	BR-S2.5FT2	Back-Up Ring	1				
C05	O-S18	"O" Ring	1	C52	BR-112	Back-Up Ring	1				
C06	O-S18	"O" Ring	1	C52	BR-S2.5FT2	Back-Up Ring	1				
C07	O-P3(H)	"O" Ring (HNBR80)	1	C53	BR-S2.5FT2	Back-Up Ring	1				
D73	SS-46D	Set Screw(Dog Point)	1	101	W-387101-00	Housing Cover	1				
J03	B-3	Steel Ball	1	140	W-377140-00	Cup Nut	1				
Z08	IZL-0003	Cable Protector	1	169	W-070169-01	Reverse Valve Washer	2				
—	5412104145	Cable Kit		207	W-369207-00	Rotor	1				
Z02		Cable Ass'y	1	208	W-369208-00	Rotor Blade	9				
Z05		Housing	1	209	W-369209-00	Cylinder	1				
Z06		Contact	8	B31	SP-2.56	Spring Pin	1				
—	W-387033-00	Front Case Ass'y		B32	SP-2.56	Spring Pin	1				
490	W-387490-00	Spindle Bushing	1	210	W-371210-00	Cylinder Upper Plate	1				
593	W-370593-00	Front Case	1	211	W-369211-00	Cylinder Lower Plate	1				
A03	BB-6701	Ball Bearing	1	(B33)	SP-25	Spring Pin	1				
C36	O-S12	"O" Ring	1	255	W-371255-00	Motor Fastening Nut	1				
L01	PL-1/16	Plug	1	372	W-387372-00	Plastic Cover	1				
—	W-387021-01	Oil Cylinder Ass'y <BF>		651	W-371651-00	Hanger (Horizontal)	1				
104	W-254104-00	Bushing	1	712A	W-300712-00	Damper	1				
226	W-184226-00	Oil Plug	1	753	W-387753-00	Piston Rod	1				
308	W-371308-00	Spacer	1	777	W-300777-00	Collar	1				
385	W-379385-00	Adjusting Screw	1	A01	BB-EE2	Ball Bearing	1				
438	W-379438-01	Spindle <BF>	1	A02	BB-6901	Ball Bearing	1				
541	W-252541-00	Button Retainer Spring	1	D01	CS-316	Cap Screw	3				
551	W-252551-00	Plug	1	D02	CS-310B	Button Head Cap Screw	2				
				E01	SW-3	Wave Washer	3				

- The related parts are shown in a thick frame.
- #209 #211 and #Z03 are supplied together with parts shown in ().
- Special tool is necessary for Cable Kit and #Z03
please contact your Fuji representative.
- For repair / replacement of electronic parts(#Z07)
please contact your Fuji representative.
- Specify parts number and quantity when ordering.

■ Standard Accessories

AC No.	Description	Qty
F-701-1	1.5mm Hex. Pin Wrench	1
F-704	4mm Hex. Pin Wrench	1
IB-202N00	Inlet Bushing (for NPT only)	1