

Fuji USER MANUAL

IMPACT WRENCHES

MODELS : FW-10PH-1, -2

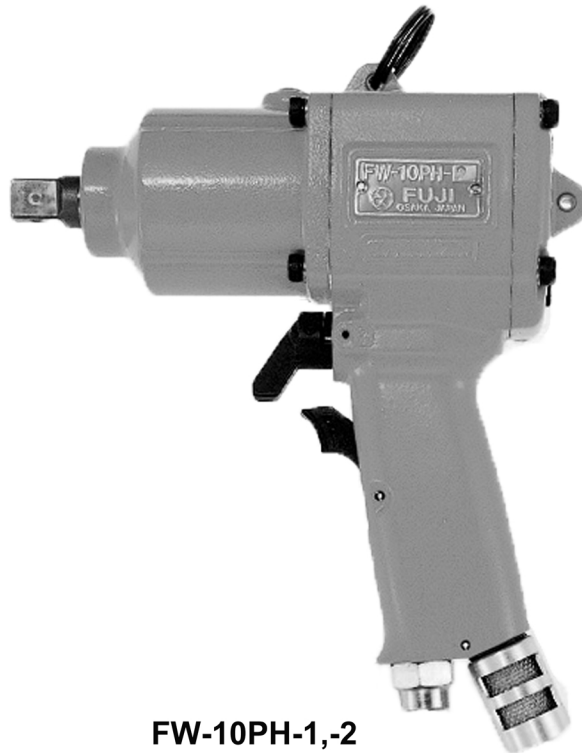

FW-10PH-1,-2

SPECIFICATIONS

MODEL	Bolt Size	Square Drive Size	Recommended Torque Range	Max. Torque (Reverse)	Rotational Frequency	Overall Length (without socket)	Mass (without socket)	Air Consumption (At Load)	Air Inlet Thread Size	Air Hose Size
	mm	mm	N·m	N·m	min ⁻¹	mm	kg	m ³ /min		mm
FW-10PH-1	M10	12.7	45 ~ 65	80	7,500	179	2.0	0.45	PT or NPT1/4	9.5
FW-10PH-2	M10	12.7	47 ~ 79	100	7,500	179	2.0	0.45	PT or NPT1/4	9.5

The performance figures are at 0.63MPa (6.3bar).

Refer to "The Instructions and Warning for Safety Use" enclosed in each tool box.

Fuji Industrial Technique Co., Ltd.

2-1-14, Kamiji, Higashinari-ku, Osaka, 537-0003 Japan

Tel : 81-6-6972-2335

Fax : 81-6-6972-2380

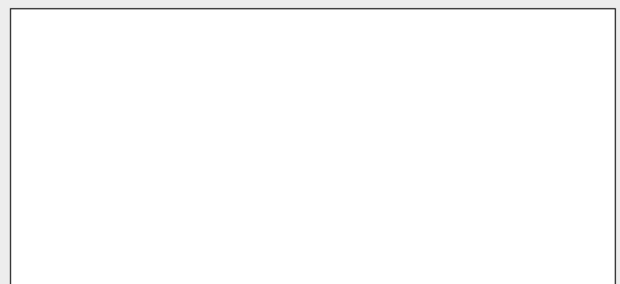

MODELS : FW-10PH-1, -2

EXPLODED VIEW

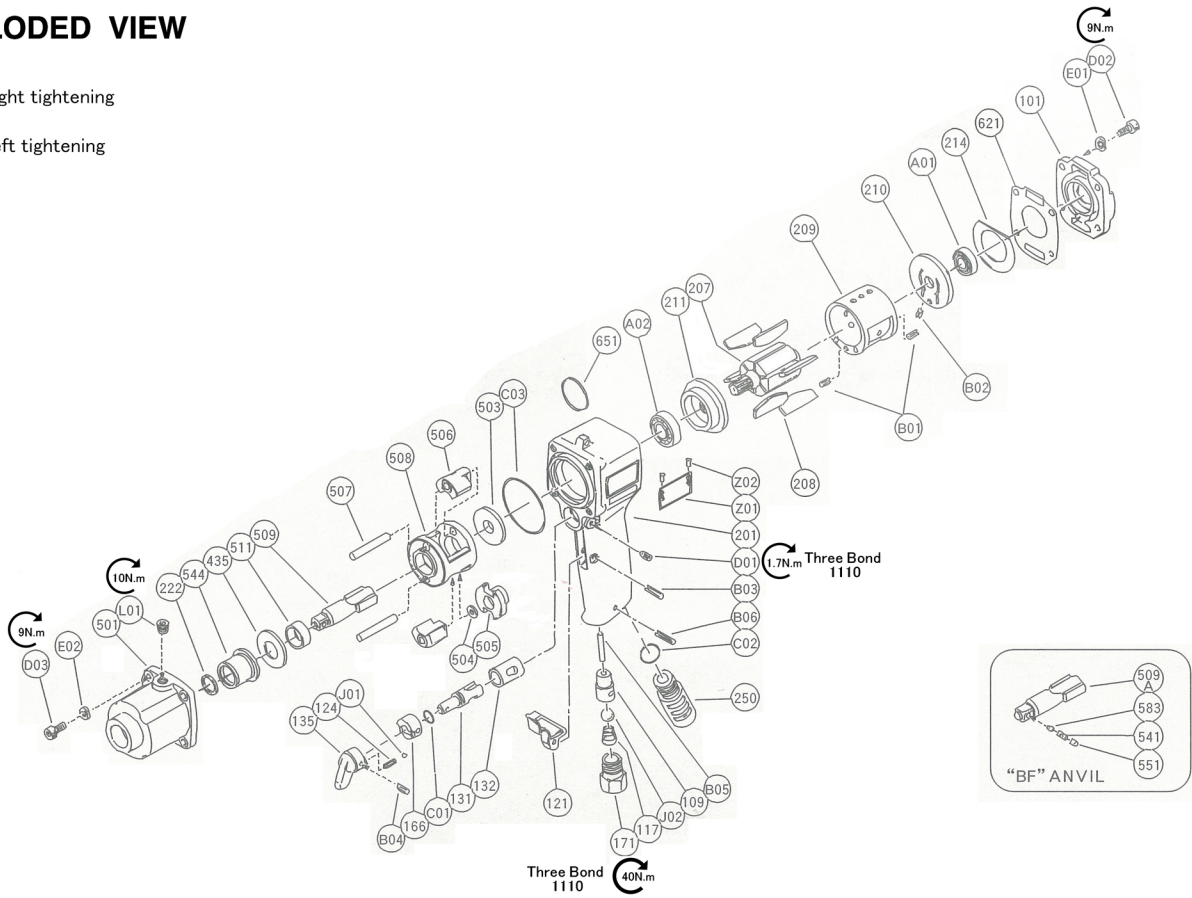
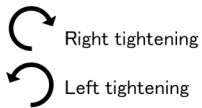

PARTS LIST

Index No.	Parts No.	Parts Name	Qty
—	W-264006-52	Housing Ass'y	
201	W-264201-02	Housing	1
(109)	W-264109-00	Throttle Valve Bushing	1
(132)	W-258132-00	Reverse Valve Bushing	1
—	W-264013-01	Clutch Housing Ass'y	
222	W-264222-00	Felt Ring	1
501	W-264501-01	Clutch Housing	1
544	W-264544-00	Clutch Housing Bushing	1
L01	PL-1/8	Plug	1
101	W-264101-01	Housing Cover	1
117	W-242117-00	Throttle Valve Spring	1
121	W-252121-00	Throttle Valve Lever	1
124	G-005124-00	Knock Spring	1
131	W-258131-00	Reverse Valve	1
135	W-225135-00	Reverse Valve Lever	1
166	W-252166-00	Reverse Valve Cover	1
171	W-242171-00	Inlet Joint <PT>	1
	W-242171-01	Inlet Joint <NPT>	1
207	W-264207-00	Rotor	1
208	W-258208-00	Rotor Blade	6
209	W-264209-00	Cylinder	1
(B01)	SP-38	Spring Pin	2
210	W-258210-00	Cylinder Upper Plate	1
(B02)	SP-26	Spring Pin	1
211	W-258211-00	Cylinder Lower Plate	1
214	W-264214-00	Adjusting Washer (Shim)	1
250	W-264250-00	Exhaust Cover	1
435	W-264435-00	Thrust Washer	1
503	W-027503-00	Spacer (B)	1
504	W-140504-00	Spacer (C)	1
505	W-140505-01	Cam	1

Index No.	Parts No.	Parts Name	Qty
506	W-140506-01	Hammer Clutch (FW-10PH-2)	2
	W-140506-02	Hammer Clutch (FW-10PH-1)	2
507	W-027507-00	Clutch Pin	2
508	W-140508-01	Clutch Frame	1
509	W-140509-07	Anvil <P>	1
511	W-027511-00	Clutch Frame Bushing	1
621	W-264621-00	Packing (A)	1
651	W-181651-00	Hanger (Horizontal)	1
A01	BB-6901	Ball Bearing	1
A02	BB-6902	Ball Bearing	1
B03	SP-318	Spring Pin	1
B04	SP-318	Spring Pin	1
B05	NR-326FR	Needle Roller	1
B06	SP-322	Spring Pin	1
C01	O-S12	"O"Ring	1
C02	O-S15	"O"Ring	1
C03	O-S53	"O"Ring	1
D01	SS-410D	Set Screw	1
D02	CS-516	Cap Screw	4
D03	CS-516	Cap Screw	4
E01	SW-5	Spring Washer	4
E02	SW-5	Spring Washer	4
J01	B-3	Ball	1
J02	B-3/8	Ball	1
Z01	NP-2048	Name Plate	1
Z02	NPN-0X3.2	Screw Rivet	2
"BF" ANVIL			
509A	W-140509-12	Anvil < BF >	1
(541)	W-224541-00	Button Retainer Spring <F>	1
551	W-224551-00	Plug	1
583	W-224583-00	Retainer Button <F>	1

- The related parts are shown in thick frame.
- #201, #209, #210 and #590A are supplied together with parts shown in ().
- Specify parts number and quantity when ordering.

■ Standard Accessory

AC No.	Description	Qty
F-705	5mm Hex. Pin Wrench	1