

Fuji USER MANUAL

SAND RAMMERS

MODELS : FR-18B, -18B-2F



FR-18B



FR-18B-2F

SPECIFICATIONS

Model	Piston Diameter	Blows	Stroke	Overall Length	Mass	Air Consumption (At Load)	Air Inlet Thread Size	Air Hose Size
	mm							Hz
FR-18B	18	30	50	294~381	1.7	0.4	Rc or NPT 1/4	9.5
FR-18B-2F	18	30	50	389~467	2.2	0.4	Rc or NPT 3/8	9.5

The performance figures are at 0.63MPa (6.3bar).



Refer to "The Instructions and Warning for Safety Use" enclosed in each tool box.

Fuji Industrial Technique Co.,Ltd.

2-1-14, Kamiji, Higashinari-ku, Osaka, 537-0003 Japan

Tel : 81-6-6972-2335

Fax : 81-6-6972-2380

ASSEMBLY TOOLS

ABRASIVE TOOLS

DRILLS / TAPPERS

PERCUSSIVE TOOLS

AIR MOTORS

OTHER PRODUCTS

MODELS : FR-18B, -18B-2F

EXPLODED VIEW

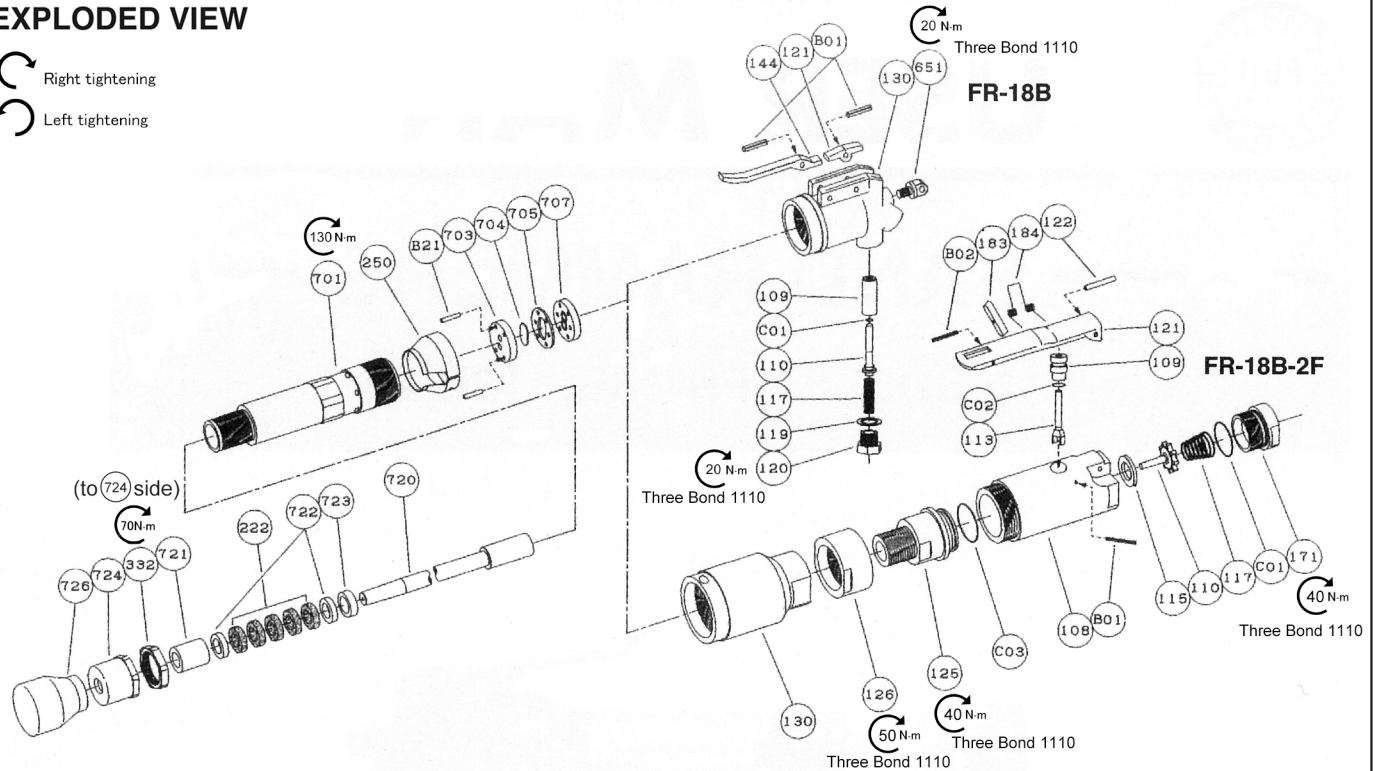
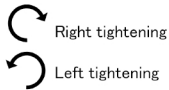

FR-18B, -18B-2F

PARTS LIST

Index No.	Parts No.	Parts Name	Qty
FR-18B			
R-001005-00 Cap Ass'y			
109	R-001109-00	Throttle Valve Bushing	1
110	R-001110-A	Throttle Valve	1
117	R-001117-00	Throttle Valve Spring	1
119	H-001119-00	Throttle Valve Cover Packing	1
120	H-001120-00	Throttle Valve Cover	1
121	R-001121-00	Throttle Valve Lever	1
130	R-001130-00	Cap	1
144	R-001144-00	Throttle Valve Lever 	1
651	R-001651-00	Hanger	1
B01	SP-420	Spring Pin	2
C01	O-P5	"O" Ring	1
222	R-001222-00	Felt Ring	5
250	R-001250-00	Exhaust Cover	1
332	R-001332-00	Lock Nut	1
701	R-001701-00	Cylinder	1
703	R-001703-00	Valve Sheet	1
704	R-001704-00	Valve	1
705	R-001705-00	Valve Case	1
707	R-001707-00	Valve Cover	1
720	R-001720-00	Piston	1
721	R-001721-00	Piston Bushing	1
722	R-001722-00	Leather Packing	2
723	R-001723-00	Packing Sheet	1
724	R-001724-00	Grand	1
726	R-1	Rubber Butt	1
B21	P-316	Pin	2

- The related parts are shown in thick frame.
- Specify parts number and quantity when ordering.

■ Standard Accessory

AC No.	Description	Qt.
IB-202N01	Inlet Bushing	1

* This accessory is provided only for FR-18B with NPT thread Air Inlet.

Index No.	Parts No.	Parts Name	Qty
FR-18B-2F			
Y-020003-00 Throttle Valve Body Ass'y <Rc>			
Y-020003-02 Throttle Valve Body Ass'y <NPT>			
108	Y-020108-00	Throttle Valve Body	1
109	Y-020109-00	Throttle Valve Bushing	1
110	Y-020110-00	Throttle Valve	1
113	Y-020113-00	Throttle Valve Rod	1
115	Y-020115-00	Throttle Valve Sheet	1
117	Y-020117-00	Throttle Valve Spring	1
121	G-144121-02	Throttle Valve Lever	1
122	H-001122-00	Throttle Valve Lever Pin	1
125	Y-020125-00	Throttle Valve Stem	1
126	Y-020126-00	Throttle Valve Stem Nut	1
171	Y-020171-00	Inlet joint <Rc>	1
	Y-020171-01	Inlet joint <NPT>	1
183	G-144183-02	Lock Key	1
184	G-144184-00	Lock Spring	1
B01	SP-220	Spring Pin	1
B02	SP-218	Spring Pin	1
C01	O-S22	"O" Ring	1
C02	O-S8	"O" Ring	1
C03	O-S25	"O" Ring	1
130	R-002130-00	Cap	1
222	R-001222-00	Felt Ring	5
250	R-001250-00	Exhaust Cover	1
332	R-001332-00	Lock Nut	1
701	R-001701-06	Cylinder	1
703	R-001703-00	Valve Sheet	1
704	R-001704-00	Valve	1
705	R-001705-00	Valve Case	1
707	R-001707-00	Valve Cover	1
720	R-001720-00	Piston	1
721	R-001721-00	Piston Bushing	1
722	R-001722-00	Leather Packing	2
723	R-001723-00	Packing Sheet	1
724	R-001724-00	Grand	1
726	R-1	Rubber Butt	1
B21	P-316	Pin	2