

Fuji USER MANUAL

EXTENDED GRINDERS

MODELS : FG-5HL-2, -2M



FG-5HL-2



FG-5HL-2M

SPECIFICATIONS

Model	Max. Dia (Grinding Wheel)		Rotational Frequency	Spindle Thread Size	Overall Length		Mass		Max. Air Consumption		Air Inlet Thread Size	Air Hose Size	
	mm	in			min ⁻¹	in	mm	in	kg	lb		m ³ /min	ft ³ /min
FG-5HL-2	100×19×12.7	4×3/4×1/2	9,000	W1/2-12	953	37 33/64	5.3	11.7	1.00	35.3	Rc 3/8	12.7	1/2
FG-5HL-2M	100×19×12.7	4×3/4×1/2	9,000	W1/2-12	1,050	41 11/32	5.4	11.9	1.00	35.3	Rc or NPT 3/8	12.7	1/2

The performance figures are at 0.63MPa (6.3bar).

⚠ Refer to "The Instructions and Warning for Safety Use" enclosed in each tool box.

Fuji Industrial Technique Co.,Ltd.

2-1-14, Kamiji, Higashinari-ku, Osaka, 537-0003 Japan

Tel : 81-6-6972-2335

Fax : 81-6-6972-2380



MODELS : FG-5HL-2, -2M

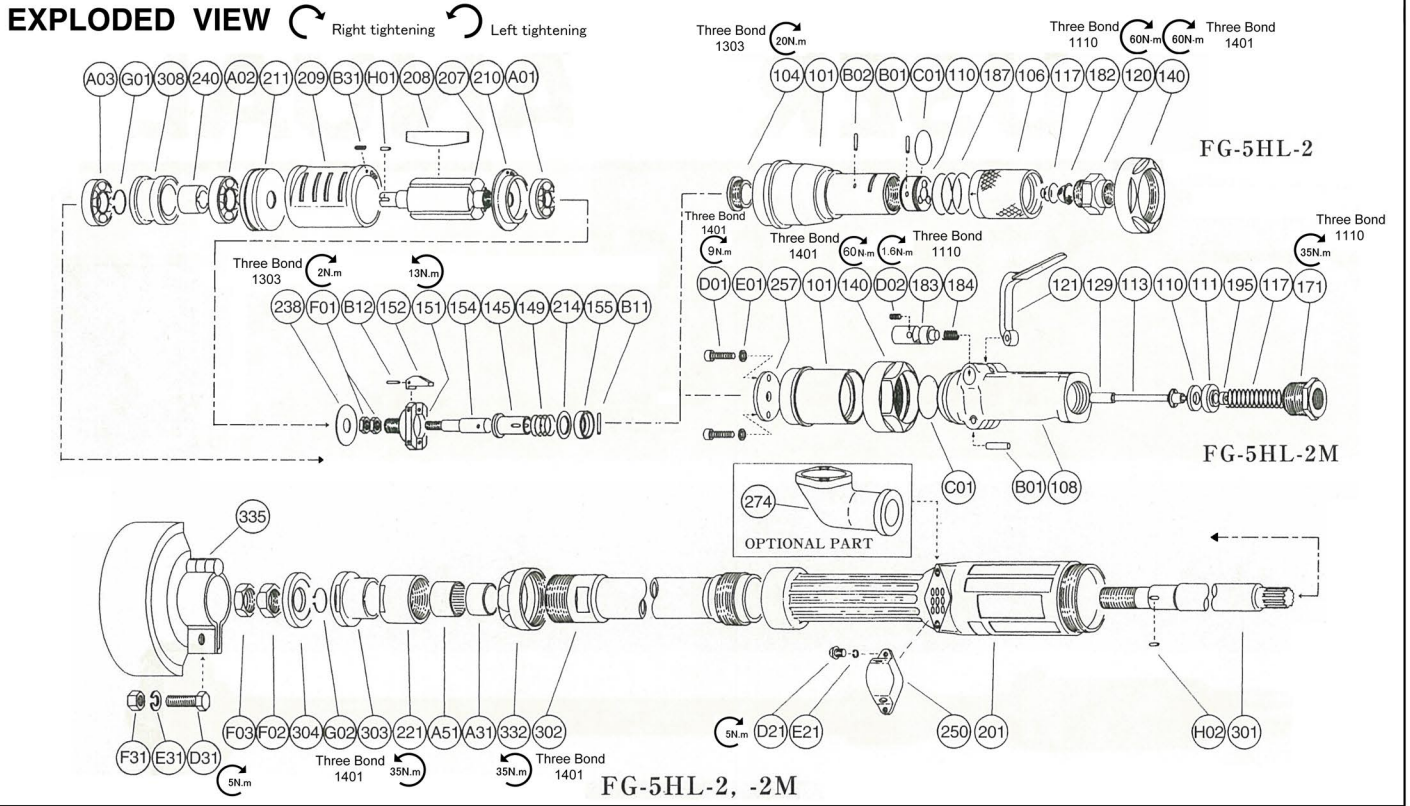

PARTS LIST

Index No.	Parts No.	Parts Name	Qty	Index No.	Parts No.	Parts Name	Qty
FG-5HL-2							
	A-086001-00	Housing Cover Ass'y < Rc >		140	G-152140-00	Cup Nut <For FG-5HL-2>	1
101	A-086101-00	Housing Cover	1	145	A-065145-00	Governor Valve	1
104	A-065104-02	Bushing	1	149	G-063149-00	Governor Valve Spring	1
106	A-086106-00	Throttle Valve Handle	1	155	A-065155-00	Governor Valve Spring Holder	1
110	A-086110-00	Throttle Valve	1	201	G-155201-00	Housing	1
117	A-086117-00	Throttle Valve Spring	1	207	A-108207-00	Rotor	1
120	A-086120-00	Throttle Valve Cover < Rc >	1	208	A-108208-00	Rotor Blade	4
182	A-086182-00	Strainer	1	209	A-108209-00	Cylinder	1
187	A-086187-00	Throttle Valve Handle Spring	1	(B31)	SP-38	Spring Pin	1
B01	NR-415	Needle Roller	1	210	A-108210-00	Cylinder Upper Plate	1
B02	NR-412.8	Needle Roller	1	211	A-108211-00	Cylinder Lower Plate	1
C01	O-S20	"O" Ring	1	214	A-065214-00	Adjusting Washer <T = 0.2>	1
FG-5HL-2M							
	A-108001-01	Housing Cover Ass'y		221	G-155221-00	Spindle Bearing Cover	1
101	A-108101-00	Housing Cover	1	238	A-108238-00	Bearing Cover 	1
140	G-152140-00	Cup Nut	1	240	G-152240-00	Coupling	1
257	A-108257-00	Washer	1	250	G-152250-00	Exhaust Cover	1
C01	O-S34	"O" Ring	1	301	G-155301-03	Wheel Spindle	1
D01	CS-518	Cap Screw	2	302	G-155302-00	Wheel Spindle Case	1
E01	SW-5	Spring Washer	2	303	G-170303-06	Wheel Flange <A>	1
	A-096003-00	Throttle Valve Body Ass'y < Rc >		304	G-170304-05	Wheel Flange 	1
	A-096003-03	Throttle Valve Body Ass'y < NPT >		308	G-152308-00	Spacer	1
108	A-096108-00	Throttle Valve Body	1	332	G-155332-00	Lock Nut	1
(129)	A-078129-00	Throttle Valve Rod Bushing	1	335	G-155335-00	Wheel Guard	1
117	A-078117-01	Throttle Valve Spring	1	(D31)	HS-625	Hexagon Bolt	1
121	A-078121-00	Throttle Valve Lever	1	(E31)	SW-6	Spring Washer	1
171	IB-6N30S0	Inlet Bushing < Rc >	1	(F31)	N-6	Nut	1
	IB-6N3NS0	Inlet Bushing < NPT >	1	A01	BB-6001	Ball Bearing	1
183	A-078183-01	Lock Key	1	A02	BB-6301	Ball Bearing	1
184	A-078184-00	Lock Spring	1	A03	BB-6202	Ball Bearing	1
B01	GP-520GCH	Grooved Pin	1	A31	NB-HK2020	Needle Bearing	1
D02	SS-48	Set Screw	1	A51	IR-172020.5	Inner Race	1
	A-078008-00	Throttle Valve Rod Ass'y		B11	NR-211.8	Needle Roller	1
110	A-078110-01	Throttle Valve	1	D21	CS-510B	Cap Screw	2
111	A-078111-01	Throttle Valve Washer	1	E21	SW-5	Spring Washer	2
113	A-078113-01	Throttle Valve Rod	1	F02	N-W1/2	Nut	1
195	W-080195-00	Sub Throttle Valve	1	F03	N-W1/2 (3)	Nut	1
FG-5HL-2, -2M							
	A-065010-03	Governor Weight Ass'y		G01	SR-S15	Snap Ring	1
151	A-065151-00	Governor Cage	1	G02	SR-E12	Snap Ring	1
152	A-010152-00	Governor Weight	2	H01	K-4410F	Key	1
154	A-108154-00	Governor Shaft	1	H02	K-4410	Key	1
B12	GP-2.516GCH	Grooved Pin	2	OPTIONAL PART			
F01	N-3	Nut	2	EXHAUST HOSE JOINT			
				274	G-170274-00	Exhaust Hose Joint	1

- The related parts are shown in the thick frame.
- #108, 209 and 335 are supplied together with parts shown in ().
- Specify parts number and quantity when ordering.

■ Standard Accessory

AC No.	Description	Qty
F-112	32mm Open-End Wrench	1