

Fuji USER MANUAL

— CHIPPING & CALKING HAMMERS —

MODELS : FC-3Z-1, -2 & FC-4Z-1, -2



FC-3Z-1, -2



FC-4Z-1, -2

SPECIFICATIONS

Model	Chisel Shank	Chisel Shank Size	Blows Per Second	Piston Diameter		Stroke		Overall Length		Mass		Air Consumption (Under Load)		Air Inlet Thread Size	Air Hose Size	
		mm	Hz	mm	in	mm	in	mm	in	kg	lb	Nm ³ /min	Nft ³ /min		mm	in
FC-3Z-1	Hex	14.8X60	38	28.5	1 1/8	76	3	386	15 13/64	6.3	13.9	0.65	23	RcorNPT3/8	12.7	1/2
FC-3Z-2	Round	17.5X60	38	28.5	1 1/8	76	3	386	15 13/64	6.3	13.9	0.65	23	RcorNPT3/8	12.7	1/2
FC-4Z-1	Hex	14.8X60	28	28.5	1 1/8	102	4	425	16 47/64	6.8	15.0	0.65	23	RcorNPT3/8	12.7	1/2
FC-4Z-2	Round	17.5X60	28	28.5	1 1/8	102	4	425	16 47/64	6.8	15.0	0.65	23	RcorNPT3/8	12.7	1/2

*The performance figures are at 0.63MPa (6.3bar) .

*Avoid unnecessary idling causing the unexpected tool's troubles.



Refer to "The Instructions and Warning for Safety Use" enclosed in each tool box.

Fuji Industrial Technique Co., Ltd.

2-1-14, Kamiji, Higashinari-ku, Osaka, 537-0003 Japan

Tel : 81-6-6972-2335

Fax : 81-6-6972-2380

MODELS : FC-3Z-1, -2 & FC-4Z-1, -2

EXPLODED VIEW

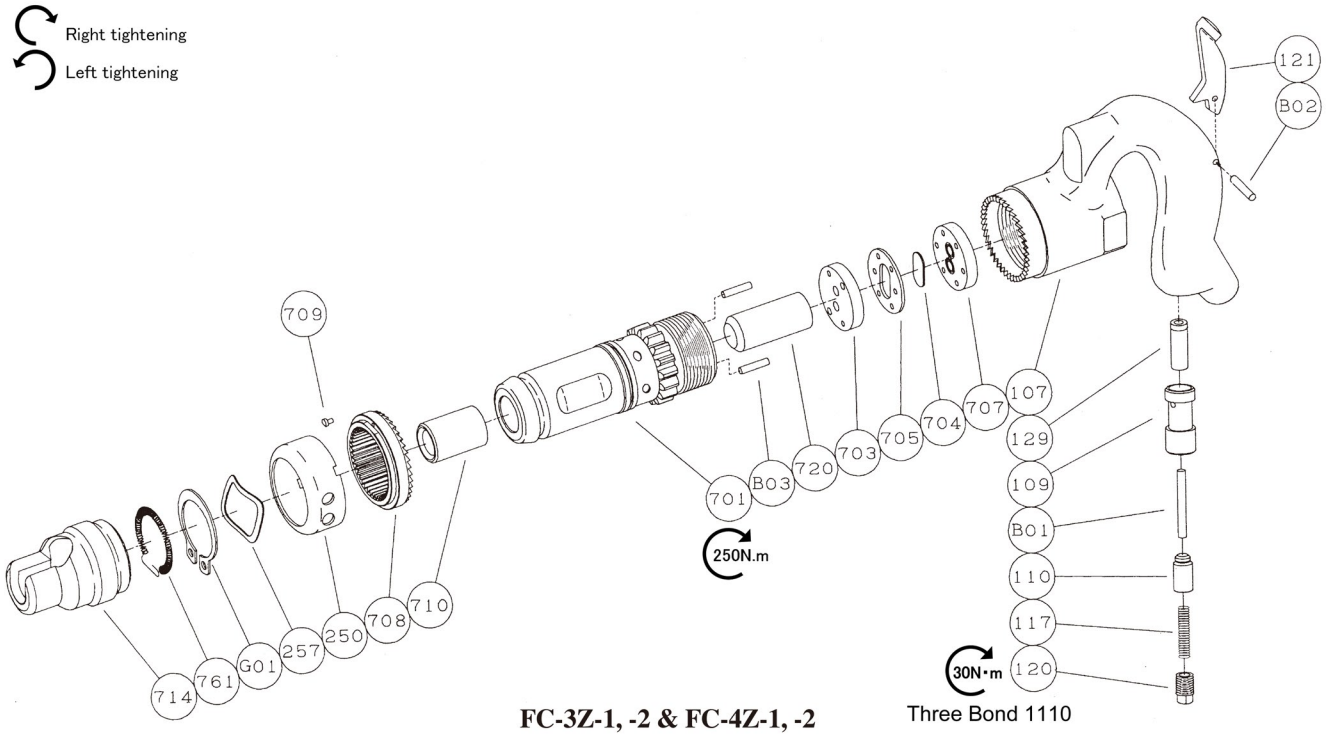

PARTS LIST

Index No.	Parts No.	Parts Name	Qty	Index No.	Parts No.	Parts Name	Qty
FC-3Z-1, -2				FC-4Z-1, -2			
—	H-047002-00	Handle Ass'y		—	H-047002-00	Handle Ass'y	
107	H-047107-01	Handle	1	107	H-047107-01	Handle	1
(109)	H-006109-00	Tbrottle Valve Busbing	1	(109)	H-006109-00	Tbrottle Valve Busbing	1
(129)	H-006129-00	Tbrottle Valve Rod Busbing	1	(129)	H-006129-00	Tbrottle Valve Rod Busbing	1
110	H-047110-00	Tbrottle Valve	1	110	H-047110-00	Tbrottle Valve	1
117	H-006117-00	Throttle Valve Spring	1	117	H-006117-00	Throttle Valve Spring	1
120	H-006120-00	Tbrottle Valve Cover	1	120	H-006120-00	Tbrottle Valve Cover	1
121	H-006121-A	Tbrottle Valve Lever	1	121	H-006121-A	Tbrottle Valve Lever	1
B01	NR-638FR	Needle Roller	1	B01	NR-638FR	Needle Roller	1
B02	NR-420	Needle Roller	1	B02	NR-420	Needle Roller	1
250	H-047250-03	Exhaust Cover	1	250	H-047250-03	Exhaust Cover	1
257	H-047257-00	Washer	1	257	H-047257-00	Washer	1
703	H-006703-00	Valve Sheet	1	703	H-006703-00	Valve Sheet	1
704	H-006704-00	Valve	1	704	H-006704-00	Valve	1
705	H-006705-00	Valve Case	1	705	H-006705-00	Valve Case	1
707	H-006707-00	Valve Case	1	707	H-006707-00	Valve Case	1
708	H-047708-00	Locking Clutch	1	708	H-047708-00	Locking Clutch	1
709	H-047709-00	Lcoking ClutchKey	1	709	H-047709-00	Lcoking ClutchKey	1
714	H-047714-01	Chise Holder	1	714	H-047714-01	Chise Holder	1
720	H-008720-00	Piston	1	720	H-009720-00	Piston	1
761	H-047761-00	Retainer Spring	1	761	H-047761-00	Retainer Spring	1
B03	P-523	Pin	2	B03	P-523	Pin	2
G01	SR-S52	Snap Ring	1	G01	SR-S52	Snap Ring	1
FC-3Z-1				FC-4Z-1			
—	H-049007-01	Cylinder Ass'y		—	H-050007-01	Cylinder Ass'y	
701		Cylinder	1	701		Cylinder	1
710		Chisel Bushing	1	710		Chisel Bushing	1
FC-3Z-2				FC-4Z-2			
—	H-049007-02	Cylinder Ass'y		—	H-050007-02	Cylinder Ass'y	
701		Cylinder	1	701		Cylinder	1
710		Chisel Bushing	1	710		Chisel Bushing	1

- Spare parts without part number are not sold separately.
- The related parts are shown in a thick frame.
- Specify parts number and quantity when ordering.
- #107 is supplied together with parts shown in ().

Standard Accessory

AC No.	Description	Qty
IB-303N01	Inlet Bushing (For NPT)	1

Optional Accessory

AC No.	Description	Qty
HN-304001	Hose Nipple	1