

Fuji USER MANUAL

ASSEMBLY TOOLS

ABRASIVE TOOLS

DRILLS / TAPPERS

PERCUSSIVE TOOLS

AIR MOTORS

OTHER PRODUCTS

— CHIPPING & CALKING HAMMERS —

MODELS : FC-1Z-1, -2 & FC-2Z-1, -2



FC-1Z-1, -2



FC-2Z-1, -2

SPECIFICATIONS

Model	Chisel Shank	Chisel Insert	Blows Hz	Piston Diameter mm	Stroke mm	Overall Lengthy mm	Mass kg	Air Consumption (at Load)	Air Inlet Thread Size	Air Hose size
		mm						m ³ /min		mm
FC-1Z-1	Hex	14.8 x 60	50	28.5	25	301	5.0	0.6	Rc or NPT 3/8	12.7
FC-1Z-2	Round	17.5x 60	50	28.5	25	301	5.0	0.6	Rc 3/8	12.7
FC-2Z-1	Hex	14.8 x 60	42	28.5	51	342	5.7	0.6	Rc or NPT 3/8	12.7
FC-2Z-2	Round	17.5x 60	42	28.5	51	342	5.7	0.6	Rc 3/8	12.7

The performance figures are at 0.63MPa (6.3bar).



Refer to "The Instructions and Warning for Safety Use" enclosed in each tool box.

Fuji Industrial Technique Co.,Ltd.

2-1-14, Kamiji, Higashinari-ku, Osaka, 537-0003 Japan

Tel : 81-6-6972-2335

Fax : 81-6-6972-2380

MODLES : FC-1Z-1, -2 & FC-2Z-1, -2

EXPLODED VIEW

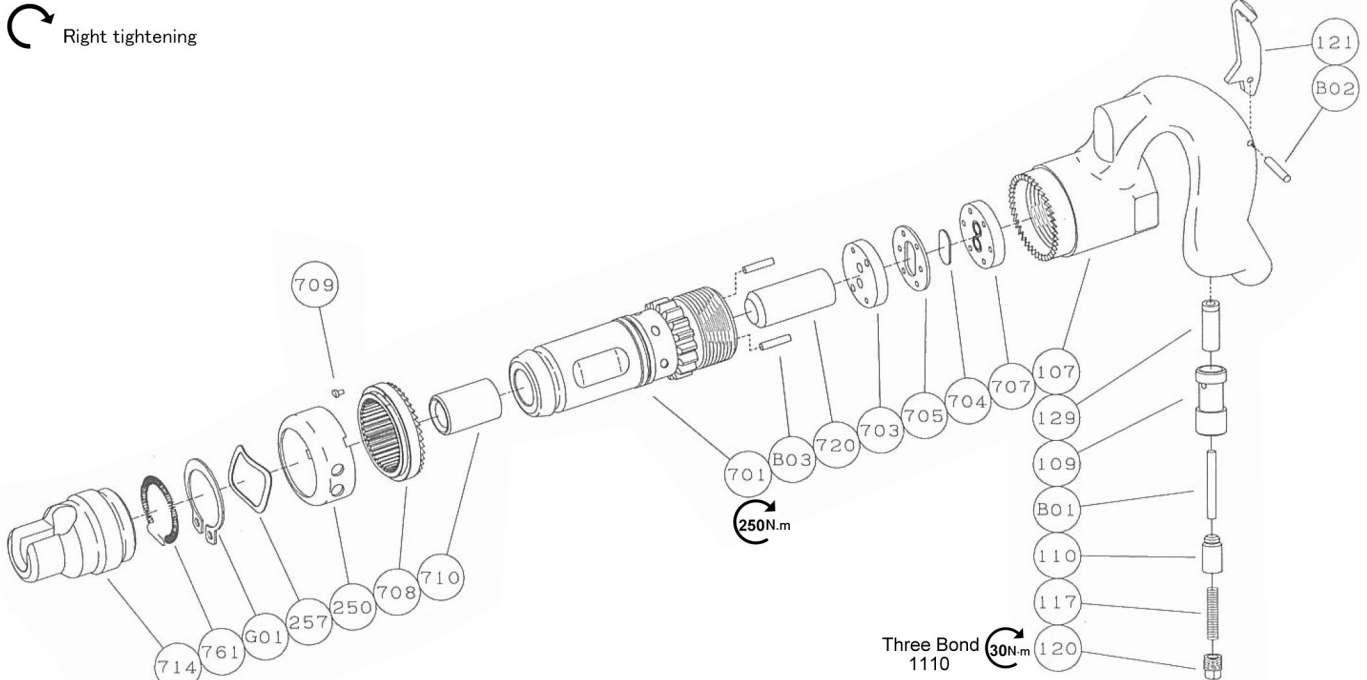

FC-1Z-1, -2 & FC-2Z-1, -2

PARTS LIST

Index No	Parts No.	Parts Name	Qty
FC-1Z-1,-2			
—	H-047002-00	Handle Ass'y	
107	H-047107-01	Handle	1
(109)	H-006109-00	Throttle Valve Bushing	1
(129)	H-006129-00	Throttle Valve Rod Bushing	1
110	H-047110-00	Throttle Valve	1
117	H-006117-00	Throttle Valve Spring	1
120	H-006120-00	Throttle Valve Cover	1
121	H-006121-A	Throttle Valve Lever	1
B01	NR-638FR	Needle Roller	1
B02	NR-420	Needle Roller	1
250	H-047250-03	Exhaust Cover	1
257	H-047257-00	Washer	1
703	H-006703-00	Valve Sheet	1
704	H-006704-00	Valve	1
705	H-006705-00	Valve Case	1
707	H-006707-00	Valve Cover	1
708	H-047708-00	Locking Clutch	1
709	H-047709-00	Locking Clutch Key	1
714	H-047714-01	Chisel Holder	1
720	H-006720-00	Piston	1
761	H-047761-00	Retainer Spring	1
B03	P-523	Pin	2
G01	SR-S52	Snap Ring	1
FC-1Z-1			
—	H-047007-01	Cylinder Ass'y	
701		Cylinder	1
710		Chisel Bushing	1
FC-1Z-2			
—	H-047007-02	Cylinder Ass'y	
701		Cylinder	1
710		Chisel Bushing	1

Index No	Parts No.	Parts Name	Qty
FC-2Z-1,-2			
—	H-047002-00	Handle Ass'y	
107	H-047107-01	Handle	1
(109)	H-006109-00	Throttle Valve Bushing	1
(129)	H-006129-00	Throttle Valve Rod Bushing	1
110	H-047110-00	Throttle Valve	1
117	H-006117-00	Throttle Valve Spring	1
120	H-006120-00	Throttle Valve Cover	1
121	H-006121-A	Throttle Valve Lever	1
B01	NR-638FR	Needle Roller	1
B02	NR-420	Needle Roller	1
250	H-047250-03	Exhaust Cover	1
257	H-047257-00	Washer	1
703	H-006703-00	Valve Sheet	1
704	H-006704-00	Valve	1
705	H-006705-00	Valve Case	1
707	H-006707-00	Valve Cover	1
708	H-047708-00	Locking Clutch	1
709	H-047709-00	Locking Clutch Key	1
714	H-047714-01	Chisel Holder	1
720	H-007720-00	Piston	1
761	H-047761-00	Retainer Spring	1
B03	P-523	Pin	2
G01	SR-S52	Snap Ring	1
FC-2Z-1			
—	H-048007-01	Cylinder Ass'y	
701		Cylinder	1
710		Chisel Bushing	1
FC-2Z-2			
—	H-048007-02	Cylinder Ass'y	
701		Cylinder	1
710		Chisel Bushing	1

- Spare parts without part number are not sold separately.
- The related parts are shown in a thick frame.
- #107 is supplied together with parts shown in ().
- Specify parts number and quantity when ordering.

■ Standard Accessory (for NPT only)

AC No.	Description	Qty
IB-303N01	Inlet Bushing	1