

# Fuji USER MANUAL

## ANGLE GRINDERS

MODELS : FA-4C-1, -1F



FA-4C-1

FA-4C-1F

### SPECIFICATIONS

Model	Max.Dia (Grinding Wheel)		Rotational Frequency min <sup>-1</sup>	Spindle Thread Size	Angle Head Height		Overall Length		Mass		Max. Air Consumption		Air Inlet Thread Size	Air Hose Size	
	mm	in			mm	in	mm	in	kg	lb	m <sup>3</sup> /min	ft <sup>3</sup> /min		mm	in
FA-4C-1	100×6×15.8	4×1/4×5/8	13,500	M8-P1.25 (F)	77	3 1/32	210	8 17/64	1.8	3.9	0.55	19.4	Rcor NPT 3/8	9.5	3/8
FA-4C-1F	100×6×15.8	4×1/4×5/8	13,500	M8-P1.25 (F)	77	3 1/32	266	10 15/32	1.8	3.9	0.55	19.4	Rcor NPT 3/8	9.5	3/8

The performance figures are at 0.63MPa (6.3bar).

⚠ Refer to "The Instructions and Warning for Safety Use" enclosed in each tool box.

Fuji Industrial Technique Co.,Ltd.

2-1-14, Kamiji, Higashinari-ku, Osaka, 537-0003 Japan

Tel : 81-6-6972-2335

Fax : 81-6-6972-2380

# MODELS : FA-4C-1, -1F

## EXPLODED VIEW

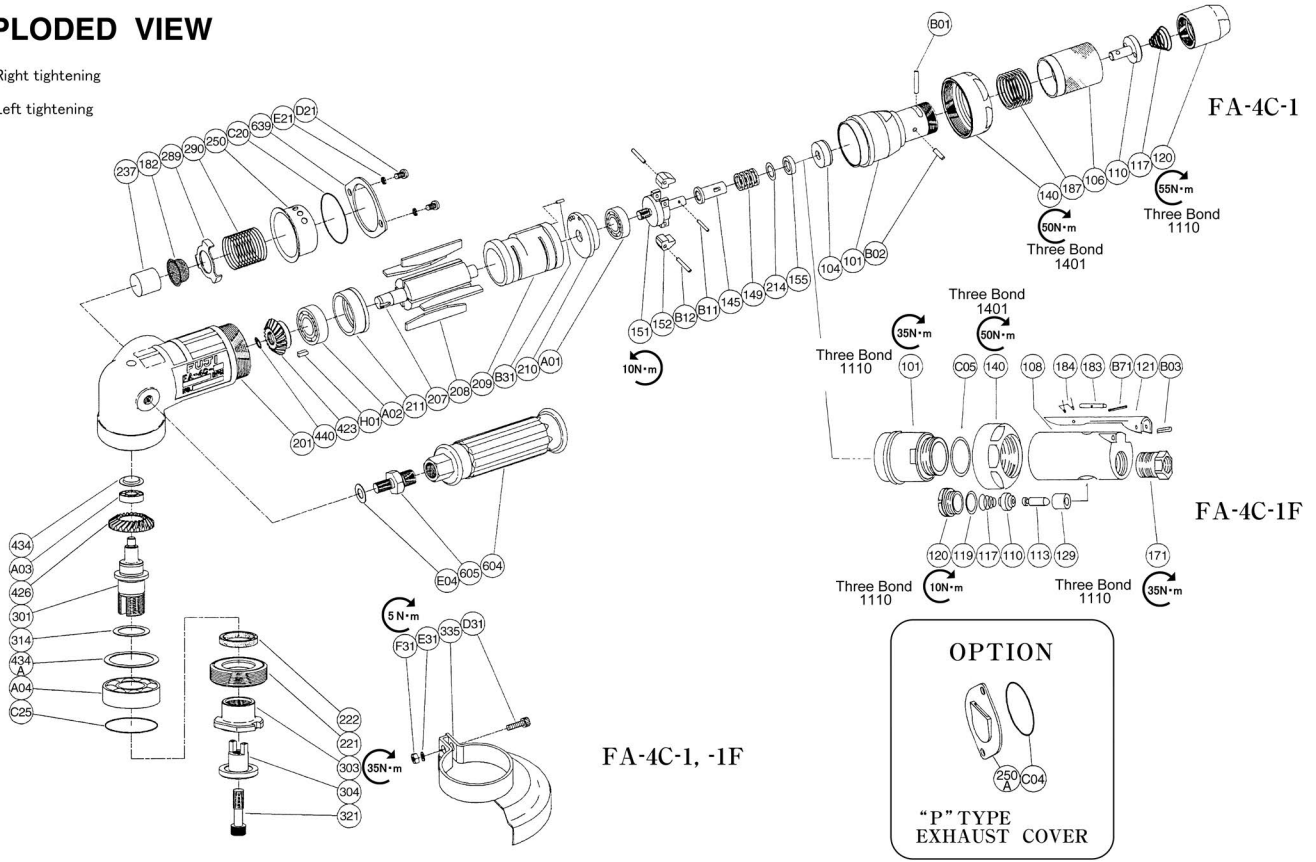
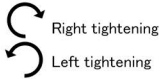

## PARTS LIST

Index No.	Parts No.	Parts Name	Qty	Index No.	Parts No.	Parts Name	Qty	Index No.	Parts No.	Parts Name	Qty			
<b>FA-4C-1</b>														
—	G-101001-00	Housing Cover Ass'y (Rc)		183	G-144183-02	Lock Key	1	303	A-093303-02	Wheel Flange (A)	1			
—	G-101001-01	Housing Cover Ass'y (NPT)		184	G-144184-00	Lock Spring	1	304	A-093304-01	Wheel Flange (B) (5/8")	1			
101	G-101001-50	Housing Cover	1	B71	SP-218	Spring Pin	1	314	A-109314-00	Wheel Spindle Washer (T=0.5)	1			
(104)	G-101104-00	Bushing	1	<b>FA-4C-1, -1F</b>								A-109314-01	Wheel Spindle Washer (T=0.3)	1
106	G-042106-04	Throttle Valve Handle	1	—	A-107010-00	Governor Weight Ass'y		A-109314-02	Wheel Spindle Washer (T=0.2)	1				
110	G-042110-00	Throttle Valve	1	151	A-107151-01	Governor Cage	1	A-021321-01	Detent Bolt	1				
117	G-042117-00	Throttle Valve Spring	1	152	A-010152-00	Governor Weight	2	A-107335-00	Wheel Guard	1				
120	G-042120-00	Throttle Valve Cover (Rc)	1	B12	GP-2.516GCH	Grooved Pin	2	(D31)	HS-625	Hexagon Bolt	1			
	G-042120-F	Throttle Valve Cover (NPT)	1	—	A-107012-00	Exhaust Cover Ass'y		(E31)	SW-6	Spring Washer	1			
187	G-042187-00	Throttle Valve Handle Spring	1	182	W-065182-00	Strainer	1	(F31)	N-6	Nut	1			
B01	NR-316.8	Needle Roller	1	237	A-094237-00	Muffler Pad	1	423	A-107423-00	Bevel Pinion	1			
B02	NR-39.8	Needle Roller	1	250	A-107250-00	Exhaust Cover	1	426	A-093426-02	Bevel Gear	1			
<b>FA-4C-1F</b>														
<b>LOCKING HANDLE LEVER TYPE</b>														
—	A-107001-00	Housing Cover Ass'y (Rc)		289	A-107289-00	Muffler Plate	1	434	A-021434-00	Bearing Washer	1			
—	A-107001-01	Housing Cover Ass'y (NPT)		290	A-107290-00	Muffler Spring	1	434A	A-093434-00	Bearing Washer	1			
101	G-161101-00	Housing Cover	1	C20	O-S40	"O" Ring	1	440	A-107440-00	Ring	1			
140	G-101140-00	Cup Nut	1	140	G-101140-00	Cup Nut (for FA-4C-1)	1	604	A-025604-02	Dead Handle	1			
C05	O-S26	"O" Ring	1	145	A-065145-00	Governor Valve	1	605	A-107605-00	Dead Handle Joint	1			
—	A-107003-00	Throttle Valve Body Ass'y (Rc)		149	A-093149-01	Governor Valve Spring	1	639	A-107639-00	Exhaust Cover Holder	1			
—	A-107003-01	Throttle Valve Body Ass'y (NPT)		155	A-065155-00	Governor Valve Spring Holder	1	A01	BB-609MN	Ball Bearing	1			
108	A-107003-50	Throttle Valve Body	1	201	A-107201-00	Housing	1	A02	BB-6200	Ball Bearing	1			
(129)	H-014129-00	Throttle Valve Rod Bushing	1	207	A-107207-00	Rotor	1	A03	BB-626	Ball Bearing	1			
110	H-001110-02	Throttle Valve	1	208	G-103208-00	Rotor Blade	4	A04	BB-6004ZZ	Ball Bearing	1			
113	G-028113-00	Throttle Valve Rod	1	209	G-161209-00	Cylinder	1	B11	NR-211.8	Needle Roller	1			
117	D-001117-00	Throttle Valve Spring	1	(B31)	SP-26	Spring Pin	1	C25	O-S40	"O" Ring	1			
119	G-028119-00	T.V. Cover Packing	1	210	A-107210-00	Cylinder Upper Plate	1	D21	CS-510B	Cap Screw	2			
120	G-028120-00	Throttle Valve Cover	1	211	A-107211-00	Cylinder Lower Plate	1	E04	PW-8	Plain Washer	1			
171	IB-4030S0	Inlet Bushing (Rc)	1	214	A-065214-00	Adjusting Washer (T=0.2)	1	E21	SW-5	Spring Washer	2			
	IB-403NS0	Inlet Bushing (NPT)	1		A-065214-01	Adjusting Washer (T=0.3)	1	H01	K-338F	Key	1			
B03	SP-320	Spring Pin	1		A-065214-02	Adjusting Washer (T=0.5)	1	<b>OPTIONAL PART</b>						
—	G-144019-01	Lock Lever Ass'y		221	A-107221-00	Spindle Bearing Cover	1	<b>"P" TYPE EXHAUST COVER</b>						
121	G-144121-02	Throttle Valve Lever	1	222	A-021222-00	Felt Ring	1	250A	A-107250-01	Exhaust Cover	1			
				301	A-093301-01	Wheel Spindle	1	C04	O-P38	"O" Ring	1			

■ Standard Accessories

AC No.	Description	Qty
F-706	6mm Hex. Pin Wrench	1
F-112	32mm Open-End Wrench	1

- The related parts are shown in thick frame.
- #101, #108, #209 and #335 are supplied together with parts shown in ( ).
- Specify parts number and quantity when ordering.